

Signs shown flat face to traffic

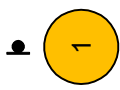

Sign Diagram Nos. shown thus

Single-lane working (Paragraphs 6 to 16) Diagram 13

When the obstruction adjoins the central reserve the arrangements will be the same except that the line of cones will run obliquely from the central reserve.

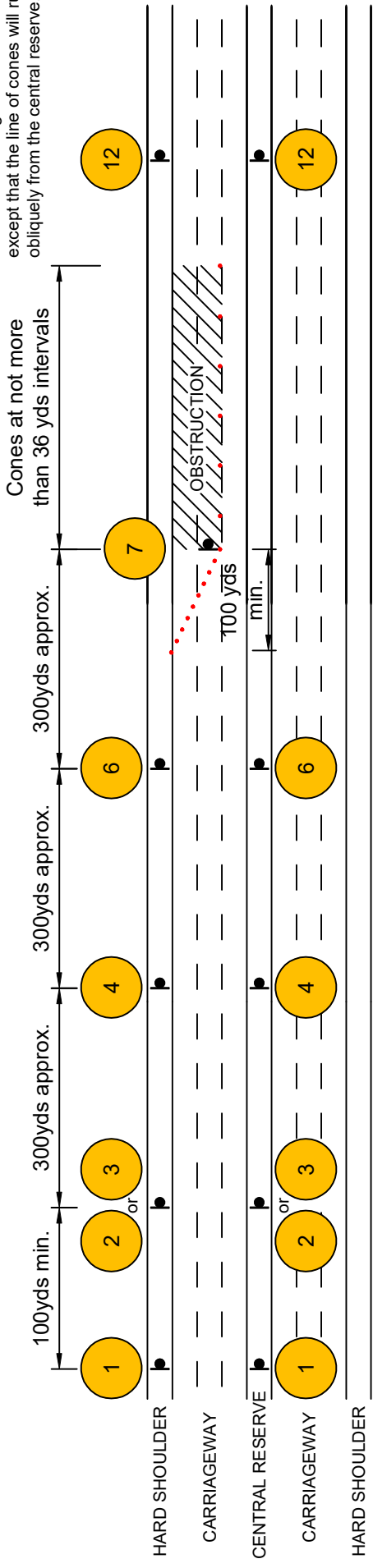

Two-lane working (Paragraphs 7) Diagram 14

When the obstruction adjoins the central reserve the arrangements will be the same except that the line of cones will run obliquely from the central reserve.

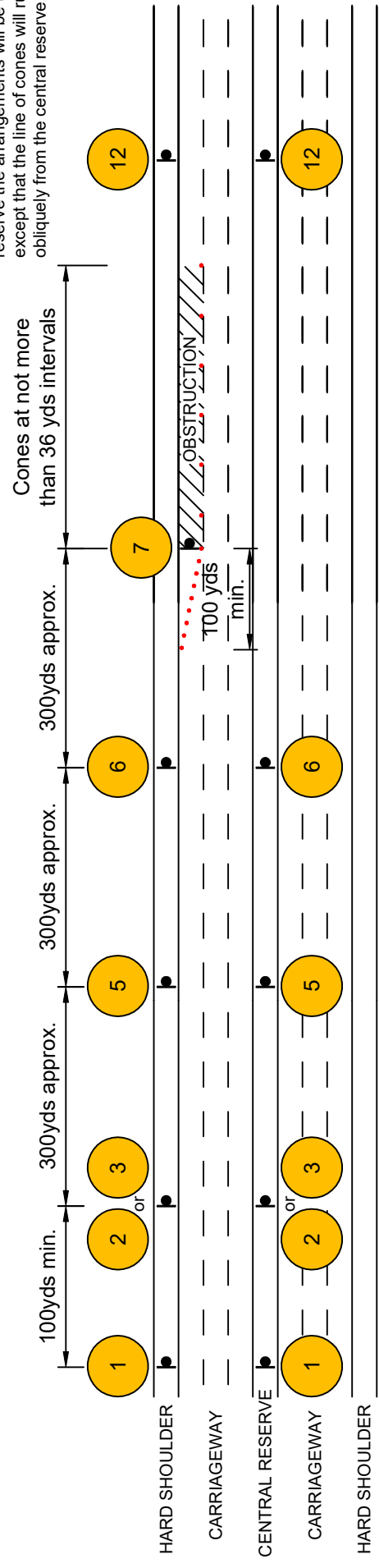

Signs shown flat face to traffic



Sign Diagram Nos. shown thus Single carriageway working (Paragraphs 20) Diagram 15

